

## V2 *Second generation*



### SPECIFICATION:

Wingspan: 1200mm  
 Length: 1100mm  
 Flying weight: 1180g  
 Servo: 9g \* 4  
 ESC: 40A Brushless ESC  
 Motor: 3536 Brushless out runner motor KV: 800  
 Battery: 14.8V 1500-2200Mah 4S Li-Po Battery



Super light EPO material  
 Super low flight function, easily to complete any 3D aerobatic function.  
 Great empty mainwing constructure, less the flight weight, much stronger mainwing to avoid any wing change or twist during flight.  
 Easy to join 2 main wing together, easy assembly, and convenient to take.  
 High quality motor and ESC, thrust ratio could be 1.7.  
 High quality details, scale appearance and great color scheme.

Please check the CG before heading to the flying field. The CG of this model should be the position as shown in the below picture. If you're a beginner, we sincerely suggest you to adjust the CG of the model plane into the front edge of the wing a little. When you're familiar with the operations, you can move the CG should fall within 25-35% of the front edge of the wing, if necessary, you can adjust the receiver or increase the weight of the model planes' head or tail to change the CG of the model plane.

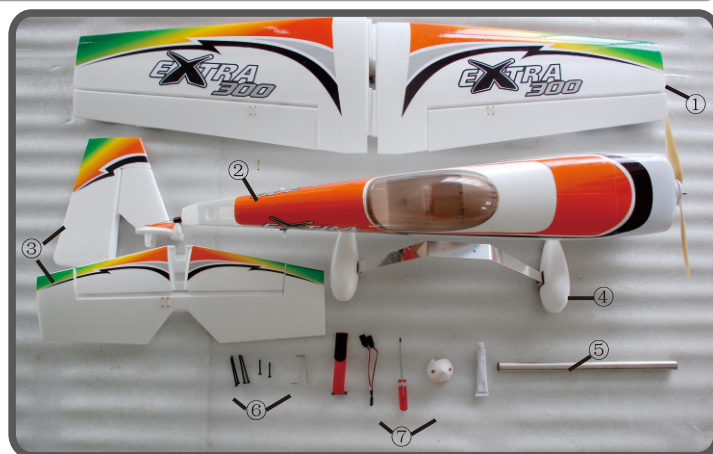
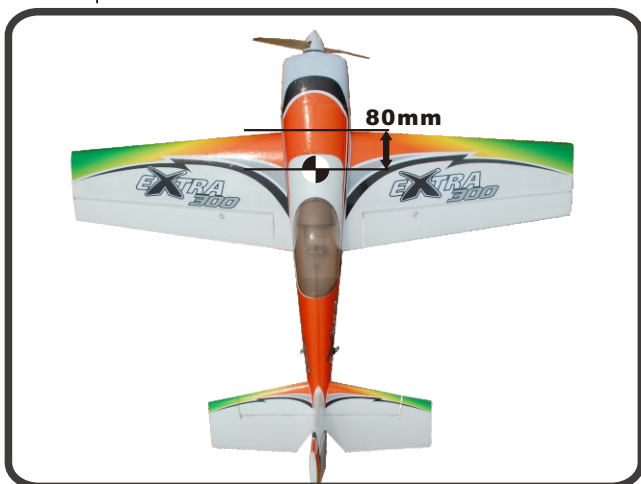

### Part list:

- 1 Main wing
- 2 Fuselage
- 3 Tail wing
- 4 Main Landing Gear
- 5 Dihedral Brace
- 6 Screws
- 7 Tool

### Warning

Always fly in an area far away from people or property. Don't forget to range check and check control surfaces before flight. Propeller is dangerous. Never try to catch the model while it flying. Always fly in a safe controlled manner. This model is not a toy. Ages 14+.

## ASSEMBLY INSTRUCTION

### (1) Install the landing gear

Take out the landing gear from the box and fix it as shown in following picture.

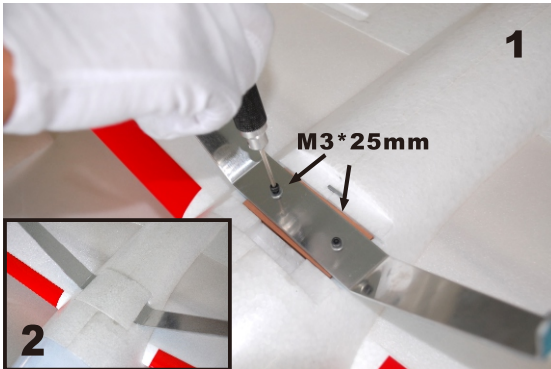

### (2) Install horizontal and vertical tails.

As shown in the following pictures, please put glue onto the connected surface of the horizontal and vertical tails, fuselage, 1 minute later, please put horizontal and verticals onto the fuselage. Meantime, please put glue on the pushrod, then insert it into fuselage.



As shown in the following picture, please connect the pushrods of rudder and elevator (Suggest to connect pushrod with the hole in most outside for first flight).

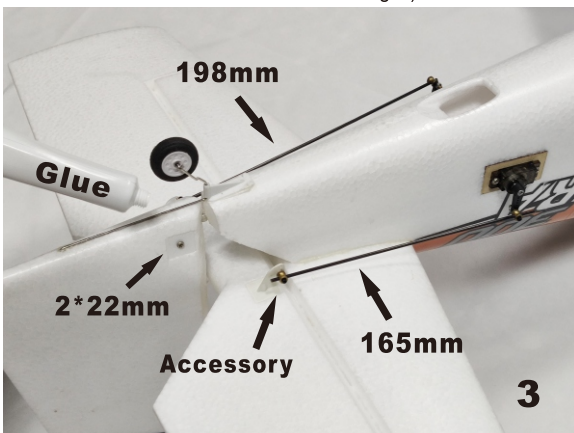

### (3) Install the main wing

Take out the main wing from the box and fix it as shown in the following pictures..

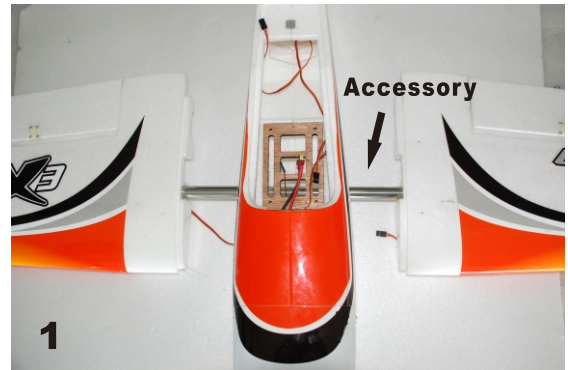

### (4) Install the propeller

Fix the propeller on the motor axis as shown in the following pictures.



MADE IN CHINA